

# Modello U-ER • U-SER

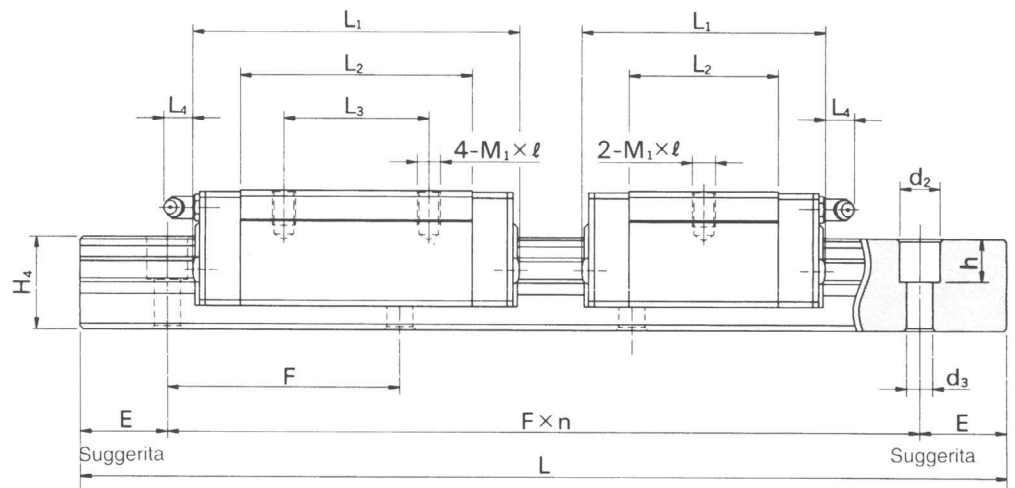
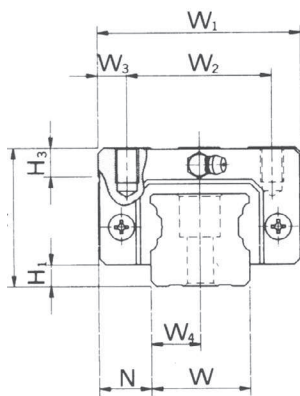

Modello	Dimensioni di montaggio			Dimensioni del cursore [mm]									Ingrassatore
	H	H <sub>1</sub>	N	W <sub>1</sub>	W <sub>2</sub>	W <sub>3</sub>	L <sub>1</sub>	L <sub>2</sub>	L <sub>3</sub>	L <sub>4</sub>	H <sub>3</sub>	M <sub>1</sub> X ℓ	
<b>U15ER</b>	24	4.6	9.5	34	26	4	58.5	38.5	26	0	6	M 4 X 5	* vedi nota
<b>U15SER</b>	24	4.6	9.5	34	26	4	45	25	-	0	6	M 4 X 5	
<b>U20ER</b>	28	4	11	42	32	5	72	50	32	0	7.5	M 5 X 7	* vedi nota
<b>U20SER</b>	28	4	11	42	32	5	52	50	-	0	7.5	M 5 X 7	
<b>U25ER</b>	33	4	12.5	48	35	6.5	83	59	35	12	8	M 6 X 8	B-M6F
<b>U25SER</b>	33	4	12.5	48	35	6.5	60	36	-	12	8	M 6 X 8	B-M6F
<b>U30ER</b>	42	7	16	60	40	10	97	68	40	12	8	M 8 X 10	B-M6F
<b>U30SER</b>	42	7	16	60	40	10	73	44	-	12	8	M 8 X 10	B-M6F
<b>U35ER</b>	48	8	18	70	50	10	112	80	50	12	10	M 8 X 12	B-M6F
<b>U35SER</b>	48	8	18	70	50	10	84	52	-	12	10	M 8 X 12	B-M6F
<b>U45ER</b>	60	11	20.5	86	60	13	139	102	60	14	15	M 10 X 16	B-PT1/8
<b>U55ER</b>	68	12	26	100	75	12.5	168	124	75	14	18	M 12 X 18	B-PT1/8

## \* NOTA

- I cursori normalmente presentano un foro Ø 3.3 profondo 3 [mm].
- A richiesta, si possono fornire separatamente gli ingrassatori (mod. NAS516-1A).

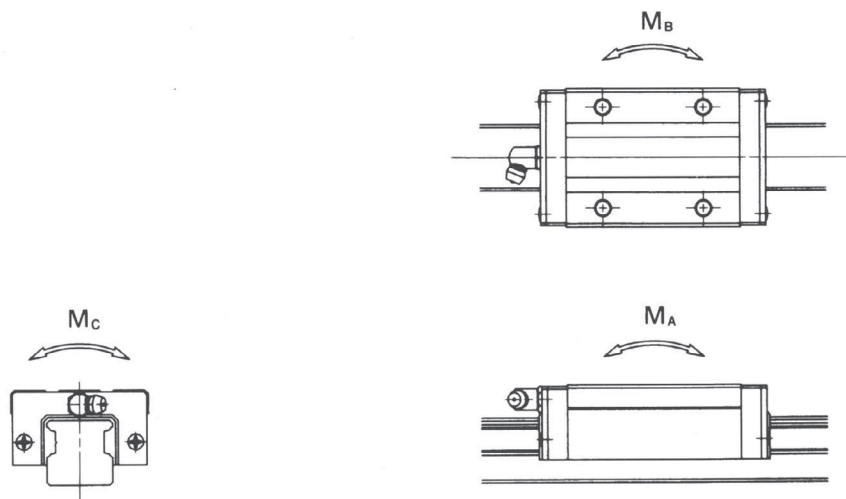

Dimensioni del binario [mm]								Capacità di carico nominale kgf		Coppia statica nominale kgf•m			Peso cursore binario kgf kgf/m		Modello
W	W <sub>4</sub>	H <sub>4</sub>	d <sub>2</sub>	d <sub>3</sub>	h	E	F	C	C <sub>o</sub>	M <sub>A</sub>	M <sub>B</sub>	M <sub>C</sub>	kgf	kgf/m	
15	7.5	17	6	3.5	9	29	60	860	1380	7	7	13	0.13	1.7	<b>U15ER</b> <b>U15SER</b>
15	7.5	17	6	3.5	9	29	60	560	750	3	3	7	0.08	1.7	
20	10	19.5	9.5	6	12	29	60	1420	2430	16	16	27	0.27	2.5	<b>U20ER</b> <b>U20SER</b>
20	10	19.5	9.5	6	12	29	60	930	1320	5	5	15	0.16	2.5	
23	11.5	21.5	11	7	12.5	29	60	2040	3510	28	28	45	0.41	3.2	<b>U25ER</b> <b>U25SER</b>
23	11.5	21.5	11	7	12.5	29	60	1340	1900	9	9	23	0.25	3.2	
28	14	28	11	7	14	39	80	2880	4780	44	44	73	0.9	5.3	<b>U30ER</b> <b>U30SER</b>
28	14	28	11	7	14	39	80	1890	2600	14	14	40	0.61	5.3	
34	17	32	14	9	15	39	80	3830	6380	65	65	115	1.3	7.5	<b>U35ER</b> <b>U35SER</b>
34	17	32	14	9	15	39	80	2950	4050	28	28	73	0.84	7.5	
45	22.5	42	17.5	11	20.5	52	105	6140	9760	133	133	235	2.2	12.9	<b>U45ER</b>
48	24	46	20	14	25	59	120	9130	13980	226	226	403	3.3	16.5	<b>U55ER</b>